

GLE

Brief overview

Mercedes-Benz



Cockpit overview

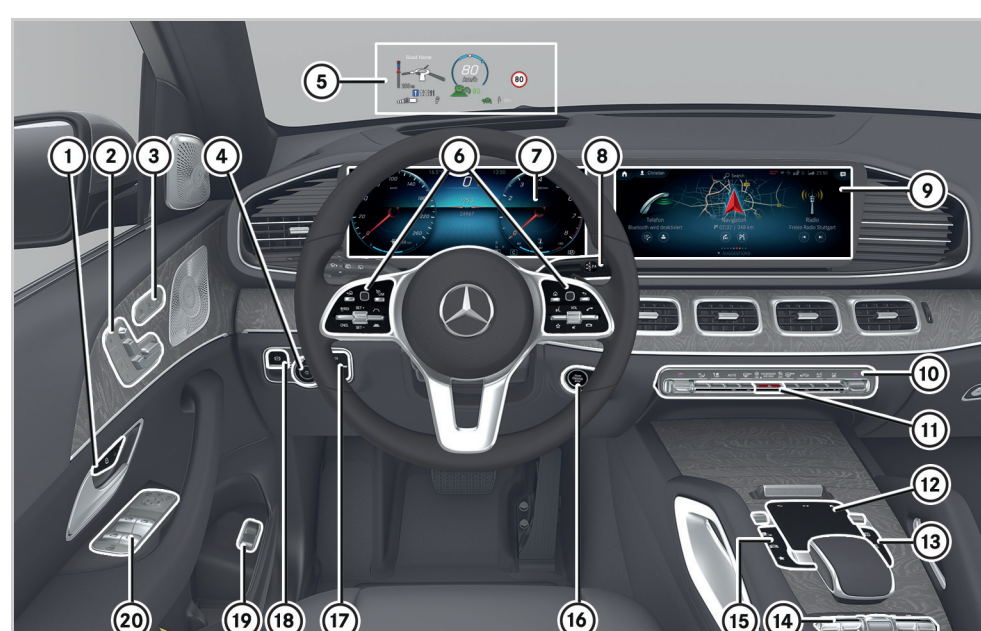

- ① **Door handle**
 - Locks the vehicle centrally
 - Unlocks the vehicle centrally
- ② **Seat functions**
 - Adjusts the seats electrically
 - Memory function and presets **1 2 3**
- ③ Switches the seat heater on/off
- Switches the seat ventilation on/off
- Adjusts the front passenger seat from the driver's seat
- ④ Light switch
- Rear fog lamp
- ⑤ Head-up Display
- ⑥ Multifunction steering wheel control panels
- ⑦ Multifunction display
- ⑧ DIRECT SELECT selector lever
- ⑨ MBUX multimedia system media display
- ⑩ Climate control system control panel
- ⑪ Hazard warning lights

⚠ WARNING Make sure that you read the entire Operator's Manual. Otherwise, you may not recognize dangers.

Cockpit overview

- ⑫ **MBUX multimedia system touchpad**
 - Back button
 - Press: audio control menu
Swipe: next/previous track or radio station
 - Displays the Home screen
- ⑬ **Buttons on the right of the touchpad**
 - Sets the volume by turning
 - Press briefly: mute function
Press and hold: switches off the MBUX multimedia system
 - Calls up Navigation
 - Calls up Radio or Media
 - Calls up Telephone
- ⑭ **Offroad control panel**
 - LOW RANGE off-road gear
 - Manual gearshifting
 - Level control system
 - ESP[®] OFF
 - DSR (Downhill Speed Regulation)

- ⑮ **Buttons on the left of the touchpad**
 - DYNAMIC SELECT switch
 - Active Parking Assist
 - Calls up vehicle functions (e.g. assistance systems)
 - Favorites button
 - Press and hold: adds a favorite
- ⑯ **Start/stop button for starting the engine**
Button for the ECO start/stop function
 - The ECO start/stop function cannot be permanently deactivated.
- ⑰ Instrument lighting
- ⑱ Electric parking brake
- ⑲ Opens or closes the tailgate
- ⑳ **Door control panel with controls for power windows, exterior mirror settings and the override feature for the rear side windows**
 - If the front passenger mirror is selected and you engage reverse gear, the front passenger mirror moves into the stored parking position.



Overhead control panel

- ① Buttons for interior lighting and reading lights
- ② Button for Mercedes me connect*
- ③ SOS button* (Mercedes-Benz emergency call system)
- ④ Opens/closes the sliding sunroof
Roller sunblind

* Not available in all countries

Note that your vehicle may not be equipped with all of the features described.

Controls on the steering wheel and Active Distance Assist DISTRONIC

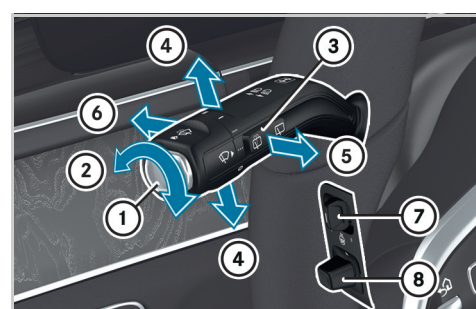

- ① Wipes the windshield once
Wipes with washer fluid
- ② Sets the windshield wipers
Off, normal/frequent automatic wiping, slow/fast continuous wiping
- ③ Rear window wiper
- ④ Turn signal, left/right
- ⑤ Headlamp flasher
- ⑥ Adaptive Highbeam Assist Plus
- ⑦ Switches the steering wheel heating on/off
- ⑧ Adjusts the steering wheel

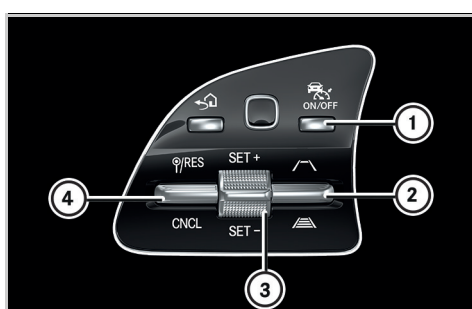

Active Distance Assist DISTRONIC

- ① Active Distance Assist DISTRONIC
- ③ Active Distance Assist
Activates DISTRONIC with current speed
- Activates with the stored speed/pulls away with Active Distance Assist DISTRONIC
- Deactivates Active Distance Assist DISTRONIC

Changing the speed/distance

- ② Reduces the specified minimum distance
- Increases the specified minimum distance
- ③ Increases the speed
- Decreases the speed

Active Distance Assist DISTRONIC maintains a constant speed which has been stored. The lowest speed that can be set is 12 mph (20 km/h).

You can change the set speed:

- 1 mph increment (1 km/h):** Briefly press rocker switch ③ up or down.
- 5 mph increment (10 km/h):** Press rocker switch ③ up or down past the point of resistance.

Using rocker switch ②, you can change the specified minimum distance to the vehicle in front. The specified minimum distance depends on the currently driven speed.

⚠ WARNING Make sure that you read the entire Operator's Manual. Otherwise, you may not recognize dangers.

Climate control



Operating possibilities

You can adjust climate control using the buttons on climate control panel ①. If you change any settings, media display ② briefly shows the current settings of the climate control system.

Air conditioning control panel

- Sets the temperature
- Calls up the air conditioning menu
Operation of further climate control functions such as the temperature setting for the 2nd row of seats, fragrancing, ionization
 - If you press and hold the **MENU** button for approximately 4 seconds, the air conditioning will be reset to the basic settings.
- Sets the air flow, switches climate control off completely
- Sets climate control to automatic mode
- Defrosts the windshield
- Defrosts the rear window
- Cooling with air dehumidification
Residual heat with the engine off
- Synchronized operation of all zones
- Air-recirculation mode
The air in the interior is recirculated; the windows may fog up more quickly.

General notes

Optimum operation of the climate control system is only achieved when the side windows and the roof are closed.

To prevent the windows from fogging up, please observe the following information:

- Switch on the cooling function.
In warm weather, the air inside the vehicle will be cooled. This function also dries the air inside the vehicle.
- As far as possible, do not switch off climate control
- Switch on air-recirculation mode only briefly
- If necessary, briefly switch on the windshield defroster function

Note that your vehicle may not be equipped with all of the features described.

Buttons on the multifunction steering wheel



Operating the multifunction display and Head-up Display

- ① Back/Home button
 - Press and hold: shows the standard display (speedometer, trip meter and rev counter)
- ② Touch Control for multifunction display and Head-up Display
Press: confirms your selection

Operating the MBUX multimedia system

- ③ Home screen
- ④ Touch Control for the MBUX multimedia system
Navigate in the menus with one-finger swiping movements
Press: confirms your selection
- ⑤ Back button
Ends a dialog with the Voice Control System

- ⑥ Accepts and makes a telephone call
- Rejects a telephone call
Ends a call
Ends a dialog with the Voice Control System
- ⑦ Sets the volume by turning
Press: switches sound on or off
- ⑧ Starts a dialog with the Voice Control System
 - Press and hold: activates the voice control system of the mobile end device currently connected
- Displays favorites



Multifunction display



WARNING Make sure that you read the entire Operator's Manual. Otherwise, you may not recognize dangers.

Adjusting the multifunction display

Content ④ can be freely selected.

- ▶ Swipe Touch Control ② to the left or right to wipe. The selected area will be highlighted.
- ▶ Swipe Touch Control ② up or down in order to select the desired display content.

The index points ⑥ show the selected display content.

Operating the menu bar

Content ⑤ can be set using menu bar ③.

- ▶ **To call up the menu bar:** press button ①.
- ▶ If you press and hold button ①, the standard display of the multifunction display is shown.
- ▶ **To select content:** swipe Touch Control ② to the left or right and press to confirm the menu.
- ▶ **To activate the Head-up Display:** swipe Touch Control ② upwards. The cursor moves upwards.
- ▶ Press Touch Control ②.

Head-up Display and MBUX Interior Assistant

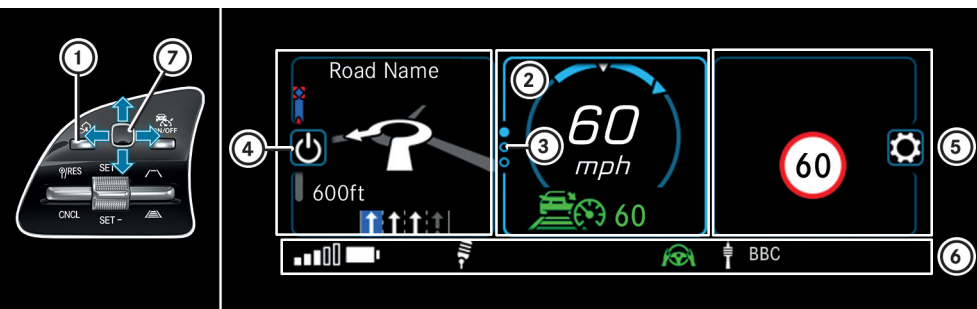

- Back/Home button
- Current cursor position, shown by means of blue highlighting
- Index point of the selected content
- Switches off the Head-up Display
- Adjusts the Head-up Display (e.g. contrast/brightness/position)
- Status information Can be switched on/off in the settings.
- Touch Control

Operating the Head-up Display

The Head-up Display has three configurable areas. You can individually adapt the content of these areas or leave them empty.

- ▶ Use Touch Control ⑦ to make swiping movements to the right and then press to confirm the menu.
- ▶ Use Touch Control ⑦ to make swiping movements upwards or downwards and then press to confirm the contents.

Quitting the Head-up Display

- ▶ Press Back/Home button ①.

Note that your vehicle may not be equipped with all of the features described.



MBUX Interior Assistant

The MBUX Interior Assistant recognizes certain hand positions and movements made in the space between the media display and center console, as well as those made on the touchpad. For example, you can switch the reading light on/off by using the back of your hand to briefly touch the rear-view mirror.

Further control functions:

- Operation of functions by moving the hand closer to the touchscreen or touchpad, e.g. adjusting seat settings.
- Calling up a previously stored favorite with a hand movement.

MBUX multimedia system Home screen

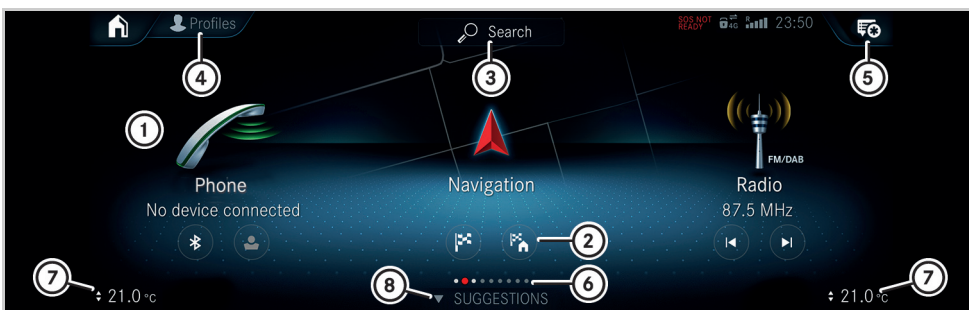

- Main applications
- Quick-access (e.g. direct destination entry or navigating home)
- Global search (search for functions in the system, e.g. Music or Navigation, as well as those external to the system, e.g. Internet)
- Creates, modifies and switches profiles You can, for example, store the seat and steering wheel position, multifunction display contents, ambient lighting settings, favorites and personalized suggestions.
- Calls up the Notifications Center
- Index points and currently selected content
- Calls up the air conditioning menu
- Calls up favorites, suggestions and themes

WARNING Make sure that you read the entire Operator's Manual. Otherwise, you may not recognize dangers.

The Voice Control System (for infotainment, navigation and vehicle functions)

Starting a dialog

For the dialog with the Voice Control System you can use complete sentences as voice commands.

- ▶ **Activation with a keyword:** Say "Hi Mercedes" and combine it with a voice command or a question.

- or
- ▶ **Activation using the rocker switch on the multifunction steering wheel:** Press upwards and after the acoustic signal say a voice command or a question.

Help functions

- **Optimal operation:** say the "Help Voice Control System" voice command.
- **Help for the current function:** Say the "Help" voice command during the dialog.
- **Help for a specific system:** Say the voice command for the desired system, e.g. "Help telephone".

You can change the language via the system language settings. If the set system language is not supported by the Voice Control System, English will be selected.

Selected examples

Navigation voice commands

- "Navigate to 25 Woodward Avenue, Detroit" Starts route guidance to an address. The order of the road, town or street number is irrelevant.
- "Navigate to John Doe" Starts route guidance to a contact from your address book.
- "Show alternative routes" The navigation shows alternative routes for route guidance.
- "Navigate to the nearest gas station." Starts route guidance to the nearest filling station.

Telephone voice commands

- "Call John Doe" The telephone number of a stored contact is dialed.
- "Read out new text messages" All new text messages will be read out.
- "Call my father on his cell number." The telephone number of the contact "Father cell" will be called.

Media/radio voice commands

- "Switch to station Z100" If you are listening to the radio, you can say the name of a station to which you would like to listen.
- "Play Bob Dylan" The system searches through the names of all available albums, tracks, artists, music genres and playlists. If the result is clear, playback starts immediately.

Vehicle voice commands

- "Open the Assistance menu"
- "Temperature 22 °C"
- "When is the next service due?"
- "Front passenger reading light on"
- "Ambient lighting to blue"
- "Head-up Display on/off"

Online voice commands

- ▶ To use this feature, you must have a connection to the Internet.
- "What will the weather be like tomorrow in Boston?"
- "Is it going to rain at my destination?"

Note that your vehicle may not be equipped with all of the features described.

Bluetooth® connection and external media sources

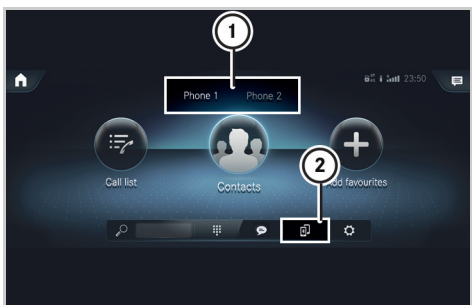

- Changing mobile phones
- Device manager

Connecting a mobile phone

Requirements:

Bluetooth® is switched on on the mobile phone and the device is visible for other devices (see the manufacturer's operating instructions).

- ▶ On the MBUX multimedia system, select >> Phone >> .

Searching for a mobile phone

- ▶ Select Connect New Device.
- ▶ Select the desired mobile phone.

If your mobile phone is not found, try searching on the mobile phone itself.

Authorizing a mobile phone

- ▶ A code is displayed in the multimedia system and on the mobile phone.
- ▶ **If the codes match:** confirm the code on the mobile phone.

Further information

Detailed information on Bluetooth® connections with your mobile phone can be found at: <https://www.mercedes-benz-mobile.com/>

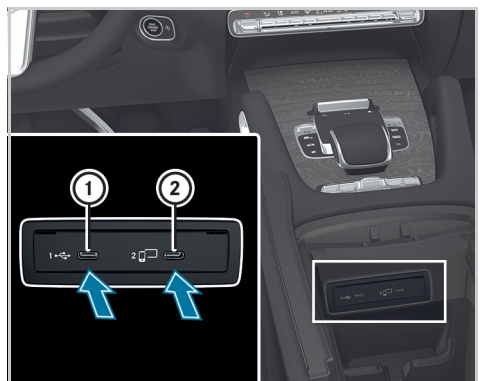

Connecting external media sources

- USB connection (type C)
- USB connection for Apple CarPlay™ or Android Auto™

Depending on the vehicle equipment, there are additional USB ports in the center console in the rear compartment or in the armrest of the rear seats or in the third row of seats.

WARNING Make sure that you read the entire Operator's Manual. Otherwise, you may not recognize dangers.

Further information on your vehicle



HANDS-FREE ACCESS

If you carry the KEYLESS-GO key on your person, you will be detected by a sensor. Do not touch the sensor and maintain a distance of around 12 in (30 cm).

- ▶ **To open or close:** kick into the center of the sensor detection range under the bumper with your foot.

- The kicking movement must be towards the vehicle and back again, and it must not be carried out too slowly.



Deactivating the KEYLESS-GO key function

If you wish to reduce the energy consumption of the key, you can deactivate the KEYLESS-GO function.

- ▶ **To deactivate:** press twice in succession on button ①. The battery check lamp of the SmartKey lights up twice briefly and once for a longer period.

- ▶ **To activate:** press any button on the SmartKey.

Further information

Further information about Mercedes-Benz vehicles and about Daimler AG can be found on the following websites:

<https://www.mbusa.com>

Mercedes-Benz Guides app

The Mercedes-Benz Guides app contains the entire Operator's Manual and is available free of charge in standard app stores.



How-to videos



Operator's Manuals

Registering with the Mercedes me portal

Register with the Mercedes me Portal to enjoy the entire range of features your vehicle has to offer.



Note that your vehicle may not be equipped with all of the features described.